



www.arnscott.com

Loudspeaker Baffles



# G11 Series

Round Acoustic Baffles for 8"  
Loudspeakers



G11W



GA11W

## FEATURES

- Powder coat finish is hard wearing and durable
- One piece construction
- Simple to install or retrofit
- Torsion spring mountes on the GA11W model, no visable screws!
- Economical design
- Some Models approved for ULC™ Listed Fire Alarm Installations



www.arnscott.com

# G11 Series

## Round Acoustic Baffles for 8" Loudspeakers

G11 Series

### SPECIFICATIONS

#### Back-boxes that work with these baffles:

Standard Screw Mount:

E10, E10-5, E10-7, E10-10, E10-7L, E10-10L, E24, SE24

Torsion Mount:

EA10

Note: All models are equipped with welded speaker mounting studs unless otherwise noted.

All baffles can be custom painted to match a particular colour scheme. Send us a colour match and we would be pleased to quote you.

In order to fulfill ULC listing requirements, this baffle must be installed on an Arnscott Fire Rated Speaker Assembly, and used with it's appropriate AEG back-box.

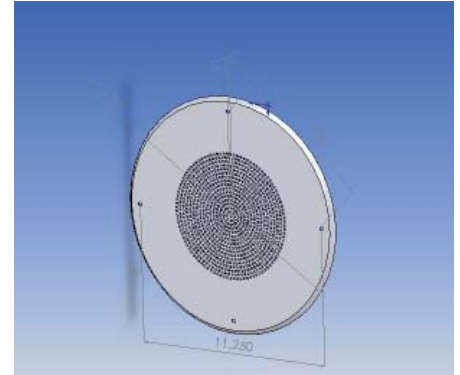

Model No.	Diameter	Mount	Flange Ht.	Spkr Mnt	Material	Finish	ULC Listed
Screw Mount:							
G11W	12-3/4"	11-1/4"	3/16"	weld studs	20 GA CRS	White Powder	Yes
G11W-14	12-3/4"	9-3/16"	3/16"	weld studs	20 GA CRS	White Powder	Yes
G11A	12-3/4"	11-1/4"	3/16"	Hardware	22 Ga. Aluminum	Natural	No
G11SS	12-3/4"	11-1/4"	3/16"	weld studs	22 Ga. Stainless	Brushed	Yes
Torsion Mount:							
GA11W	12-3/4"	N/A	3/16"	weld studs	20 GA CRS	White Powder	No

Note: G11W-14 is designed to mount to AEG E14 back-box for flush concrete applications.

### ARCHITECTS AND ENGINEERS SPECIFICATIONS

#### MODEL G11W / G11SS / G11W-14

The flush ceiling baffle shall be an ARNSCOTT Model G11W / G11SS / G11W-14. The baffle shall be fabricated from one piece of steel (G11SS fabricated from 0.035" brushed stainless steel), finished in semi-gloss white powder paint (G11SS is not painted, natural brushed finish) and shall measure 32.4cm (12-3/4") round and 0.5cm (3/16") deep. The 8-inch loudspeaker shall mount on concealed studs. Four holes shall be provided to mount the baffle to ARNSCOTT Model E10, E10-5, E10-7(L), E10-10(L), E10S or E24, SE24 recessed enclosures. The G11W-14 mounts to AEG model E11 back-box.

#### MODEL GA11W

The flush ceiling baffle shall be an ARNSCOTT Model GA11W. The baffle shall be fabricated from one piece of steel, finished in semi-gloss white powder paint and shall measure 32.4cm (12-3/4") round and 0.5cm (3/16") deep. The 8-inch loudspeaker shall mount on concealed studs. Concealed torsion springs shall be provided to mount the baffle to ARNSCOTT Model EA10, or special ordered EA10-10 recessed enclosures.

#### MODEL G11A

The flush ceiling baffle shall be an ARNSCOTT Model G11A. The baffle shall be fabricated from one piece of 0.030" aluminum, with a natural finish. G11AW is available as a special order with a semi-gloss white powder paint finish. The baffle shall measure 32.4cm (12-3/4") round and 0.5cm (3/16") deep. The 8-inch loudspeaker shall mount with four screws and nuts, the screw heads are visible from the front of the baffle. Four holes shall be provided to mount the baffle to ARNSCOTT Model E10, E10-5, E10-7, E10-10, E10S or E24 recessed enclosures.

ULC is a Trademark of Underwriters Laboratories of Canada