

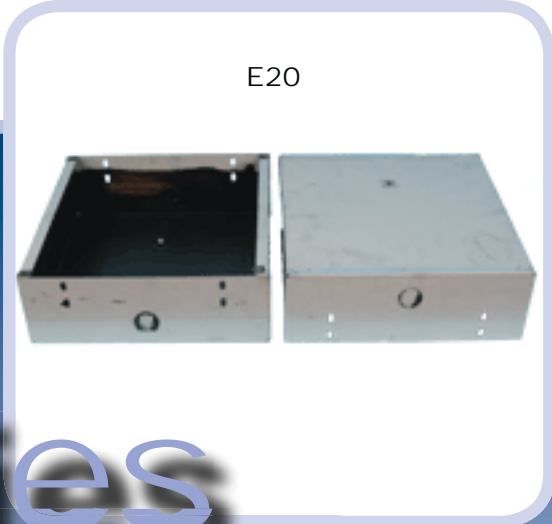

www.arnscott.com

Acoustic Back-Boxes



E20

E20 Series

E20 Series

Square Acoustic Back-Boxes for 8" Loudspeakers



SE20SB-12



SE20SB

FEATURES

- Rust resistant heavy gauge electro-plated steel
- Mounting slots punched into the sides of the flush mount boxes for easy mounting to the MC1-P Mounting Channels
- Some Models acoustically treated interior helps reduce mechanical resonance
- Custom depths and k/o configurations are available
- Some Models are approved for ULC™ Listed Installations
- Surface and flush mounting options available

E20 Series

Square Acoustic Back-Boxes for 8" Loudspeakers

E20 Series

SPECIFICATIONS

Baffles that work with these back-boxes:
Standard Screw Mount:
G25W, G25WNS, G25WS, G51W, G76SS,

Note: k/o's are 2" centered from the back on the sides at 90 degrees from each other. This applies to all flush models.
All back-boxes can be custom configured, send us a drawing or sketch and we would be pleased to quote you.
In order to fulfill ULC listing requirements, this back box must be installed with an Arnscott Fire Rated Speaker.

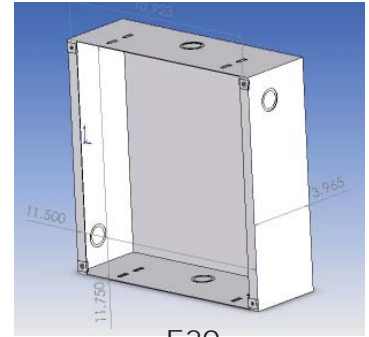

E20

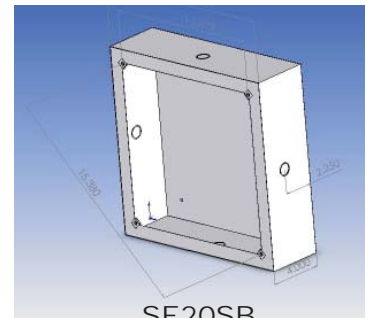

SE20SB

Model No.	Depth	Lined	Spray Dampened	Cubic Feet	Mounting	ULC Listed
Screw Mount:						
E20	4"	No	Yes	0.31	MF1, MC1-P	Yes
SE20SB	4"	No	No	0.37	Surface	Yes
SE20SS	4"	No	No	0.37	Surface	No
SE20SB-12	12"	Yes	No	1.17	Surface	No

ARCHITECTS AND ENGINEERS SPECIFICATIONS

MODELS E20 (Flush, Screw Type)

The ceiling BACKBOX shall be AEG Model E20. The back-box shall be constructed of electro-plated steel and shall have the interior coated with resonance damping material. Four combination 1/2" - 3/4" knockouts for conduit are provided. The unit shall measure 29.8cm (11-3/4") square, and have a maximum depth of 10.2 cm (4") (See chart above for complete information). These units shall be used wherever recessed ceiling or wall mount conditions exist, including concrete applications. The E20 is ULC listed and is equipped with a ground screw. These backboxes shall accommodate AEG baffle Models G25W, G25WNS, G25WS, G51W and Clean room cover G76SS.

MODEL SE20SB / SE20SS / SE20SB-12

The ceiling backbox shall be AEG Model SE20SB. The backbox shall be constructed of heavy gauge steel and shall be painted with white powder paint. Three combination 1/2" - 3/4" knockouts for conduit shall be provided, one on each side and one centered on the back. The unit shall measure 32.4cm (12-3/4") square, and have a maximum depth of 10.2cm (4"). Ground Screw is included. This unit shall be used wherever surface ceiling or wall mount conditions exist. This unit can be mounted directly onto concrete. This unit has the back completely closed, allowing the containment of wiring. The SE20SB is U.L.C. approved for use with a fire alarm system. The SE20SS is a fully welded version on the SE20SB, made from Stainless steel, primarily designed for clean room applications. The SE20SB-12 is a 12" deep version of the SE20SB and is primarily designed for big box stores to be vertically hung and usually includes better quality loudspeakers. These backboxes shall accommodate AEG baffle Models G25W, G25WS, G25WNS, G51W and G76SS clean room cover.

ULC is a Trademark of Underwriters Laboratories of Canada